

Dryer Boosting Fan Specifications

DBF 110 (FR110 Fan)

Dimensions

model	D	d	a	b	c
FR110	9½"	3⅞"	5¼"	7⁄8"	¾"

All dimensions in inches.

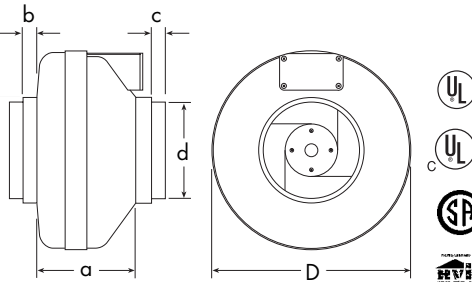

Air Performance Data

Fan Model	Max. RPM	Watts	Max. Amps	CFM VS. STATIC PRESSURE								Max. Ps	Duct Dia.
				0"	.2"	.4"	.6"	.8"	1.0"	1.5"			
FR110	2761	58-75	0.72	167	150	133	113	88	63	4		1.60"	4"

FR110 performance is shown with ducted outlet. Per HVI's Certified Ratings Program, charted air flow performance has been derated by a factor based on actual test results and the certified rate at .2 inches W.G.



DBF 4XL

Dimensions

model	D	d	a	b	c
DBF4XL	9½"	4"	6"	7⁄8"	7⁄8"

All dimensions in inches.

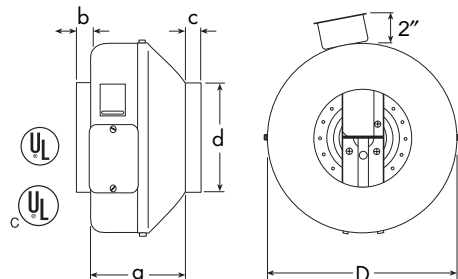

Air Performance Data

Fan Model	Max. RPM	Max. Watts	Max. Amps	CFM VS. STATIC PRESSURE								Max. Ps	Duct Dia.
				0"	.125"	.25"	.375"	.5"	.75"	1.0"	1.25"		
DBF4XL	2800	75	0.67	148	139	130	120	111	90	68	42	1.65"	4"

Performance shown is for installation type D - Ducted inlet, Ducted outlet. Speed (RPM) shown is nominal. Performance is based on actual speed of test. Performance ratings do not include the effects of appurtenances in the airstream.

RVF 4XL

Dimensions

model	a	b	c	d	e	f	g
RVF 4XL	10¼"	13"	6"	1½"	3⅞"	2¾"	5½"

All dimensions in inches.

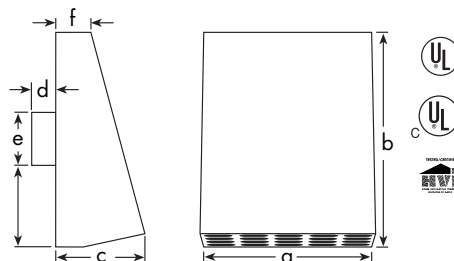

Air Performance Data

Fan Model	Max. RPM	Watts	Max. Amps	CFM VS. STATIC PRESSURE									Max. Ps	Duct Dia.
				0"	.1"	.2"	.4"	.6"	.8"	1.0"	1.2"	1.4"		
RVF4XL	2690	73-92	0.84	190	180	172	154	136	118	91	57	28	1.61"	4"

RVF 4XL performance is shown with ducted inlet. Per HVI's Certified Ratings Program, charted air flow performance has been derated by a factor based on actual test results and the certified rate at .1 inches W.G..

